

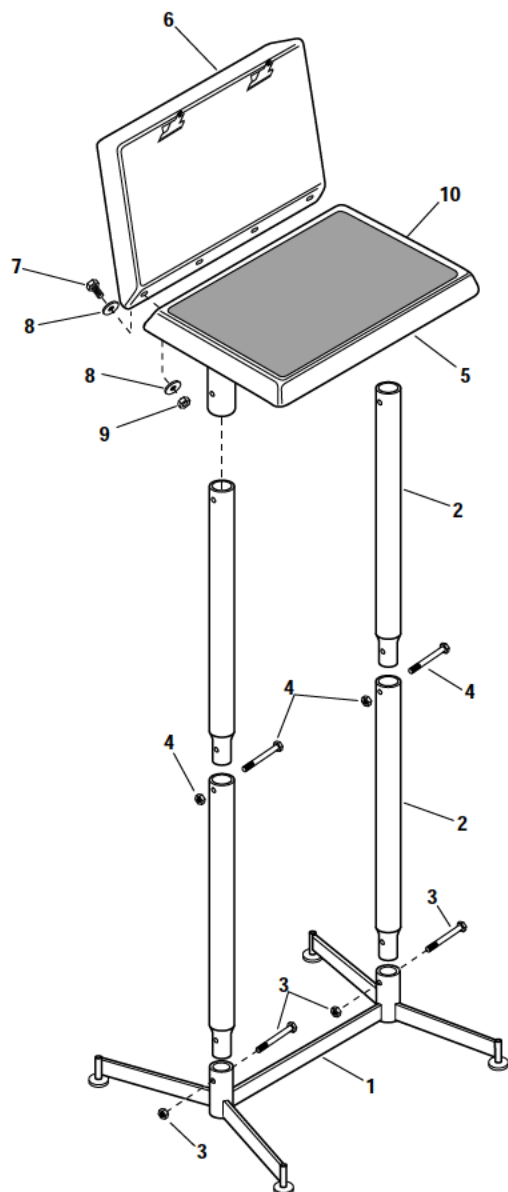

Assembly Instructions 2700S Inspection Stand



NOTE: This stand may be assembled with writing surface (item 5) at a height suitable for either standing use or seated use. To assemble for seated use, substitute 11" long post section for 22 1/2" long section (item 2).

Refer to illustration at left. *NOTE: The unit you are assembling may look slightly different than the illustration.*

1. Identify posts for stand (items 2).
2. Snap glides into base (1).
3. Slide ends of lower posts (2) onto base (1). Secure with screws, nuts (3) and setscrews. Slide upper posts into tops of lower posts. Secure with screws and nuts (4). Tighten all securely.
4. Slide inspection panel (5) onto top of stand posts (detail 1). Secure with screws and nuts (C on detail 1). Tighten.
5. Assemble display panel (6) to inspection panel (5) using four bolts, flat washers and hex nuts (7, 8, 9). Tighten securely.
6. Install neoprene pad (10) on inspection panel.

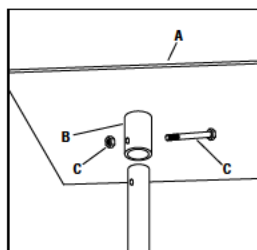

-Detail 1-
Assembling writing
surface to post.



Workplace Solutions

600 South Clark St.
Mayville, WI 53050
Phone: 920-387-4120
Fax: 920-387-4189

Part No. 2692.c



Zampini Industrial Group

Trusted Industrial Suppliers Since 1986

85 Industrial Circle, Suite 2211

Lincoln, RI 02865

USA

Factory Authorized Gleason Reel Suppliers
FAST Quotes, FAST Delivery!



ZAMPINI INDUSTRIAL GROUP



Contact Us For Your Gleason Reel Products and Parts Today!

Email Us

Call Us

Fax Us



info@AirToolPro.com

1-800-353-4676
1-401-305-7997

1-401-305-7988



We Respond **FAST!**
Minimize Your Downtime!



Numerous Ways To Get Pricing



Guaranteed Satisfaction!
Excellent Service Since 1967!



Everyday Discounts
Quantity Discounts
Email Specials
Low Price Guarantee