

RATCHET LOCK USE

Engage ratchet lock by pulling cable out to desired position and letting it retract **SLOWLY** until lock engages. To release lock, quickly pull cable out a short distance and allow it to begin to retract—it operates like a window shade. Locking feature may be turned off by turning knob on side of reel.

DANGER

DO NOT allow cable to retract in an uncontrolled manner. Always guide cable back to reel. Failure to do so can result in damage to reel or personal injury.

SERVICE

REGULAR MAINTENANCE

1. Reel is factory lubricated for life. No additional lubrication is required.
2. Periodically check cable for wear. **If wear is detected, cable should be replaced immediately.** If cable replacement is required, order cable Assembly Kit No.5 which contains cable and related parts, hardware and instructions. See Parts List (inside) for details.

SPRING REPLACEMENT

Spring motors are self-contained for safe and easy handling. If spring motor replacement is required, it should be replaced as a unit by ordering Spring Motor Assembly Kit No. 1 which contains the spring motor, spool, shaft & bushings in a sealed canister. See Parts List (inside) for details.

DANGER

DO NOT attempt to remove spring motor from its canister. Doing so can result in damage to reel or personal injury.

RATCHET LOCK REPLACEMENT

For your convenience, the ratchet lock assembly has been included in two separate replacement kits. Order either the Hardware Assembly Kit No. 6, or the RH Housing Assembly Kit No. 2. See Parts List (inside) for details.



Workplace Solutions

600 South Clark St.
Mayville, WI 53050

Phone: 920-387-4120 Fax: 920-387-4189
www.hubbell.com/gleasonreel/en

INSTALLATION & MAINTENANCE INSTRUCTIONS

STATIC DISCHARGE REELS

INSTALLATION

CAUTION

Be sure reel base is securely grounded to mounting surface. Check for continuity following installation. On painted surfaces, remove paint at bolt location, use external tooth lockwashers, or run ground wire from reel base to grounded object. Failure to ground will prevent reel from performing its intended function and could result in personal injury.

Mount reel to grounded, metal surface using four holes in mounting base. To minimize wear on cable and cable guide, reel should be mounted in direct line with work so that cable is pulled out as straight as possible during use. See figures 1 & 2.

Figure 1

Avoid pulling cable out of reel at an angle.

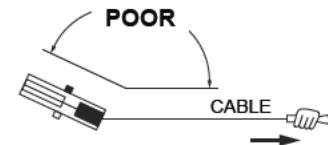
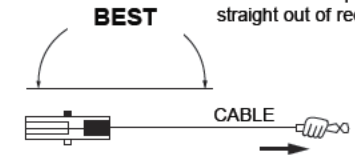

Figure 2

For best results and long cable life, mount reel so that cable can be pulled straight out of reel.



TENSION ADJUSTMENT

INCREASE TENSION if reel will not completely wind cable so that cable stop reaches guide.

1. Allow cable to retract as far as possible.
2. Place wrench on flats of shaft. Turn shaft **counter-clockwise** until cable stop reaches guide.

DECREASING TENSION is NOT recommended and should not be necessary as the reel is shipped with minimum tension required to wind installed cable.

1. Turn ratchet lock to "OFF" (knob is located on side of reel).
2. Place wrench on flats of shaft.
3. Hold shaft **firmly** with wrench. Depress spring on opposite side of reel.
4. Allow shaft to turn **SLOWLY** in **clockwise** direction until desired tension is achieved. If shaft will not turn in clockwise direction **UNASSISTED**, reel is at minimum tension and further tension reduction should not be attempted.

DANGER

DO NOT allow spring to unwind in an uncontrolled manner. Doing so can result in damage to reel or personal injury.

STATIC DISCHARGE REEL ILLUSTRATED PARTS LIST

Replacement parts available as kits only.

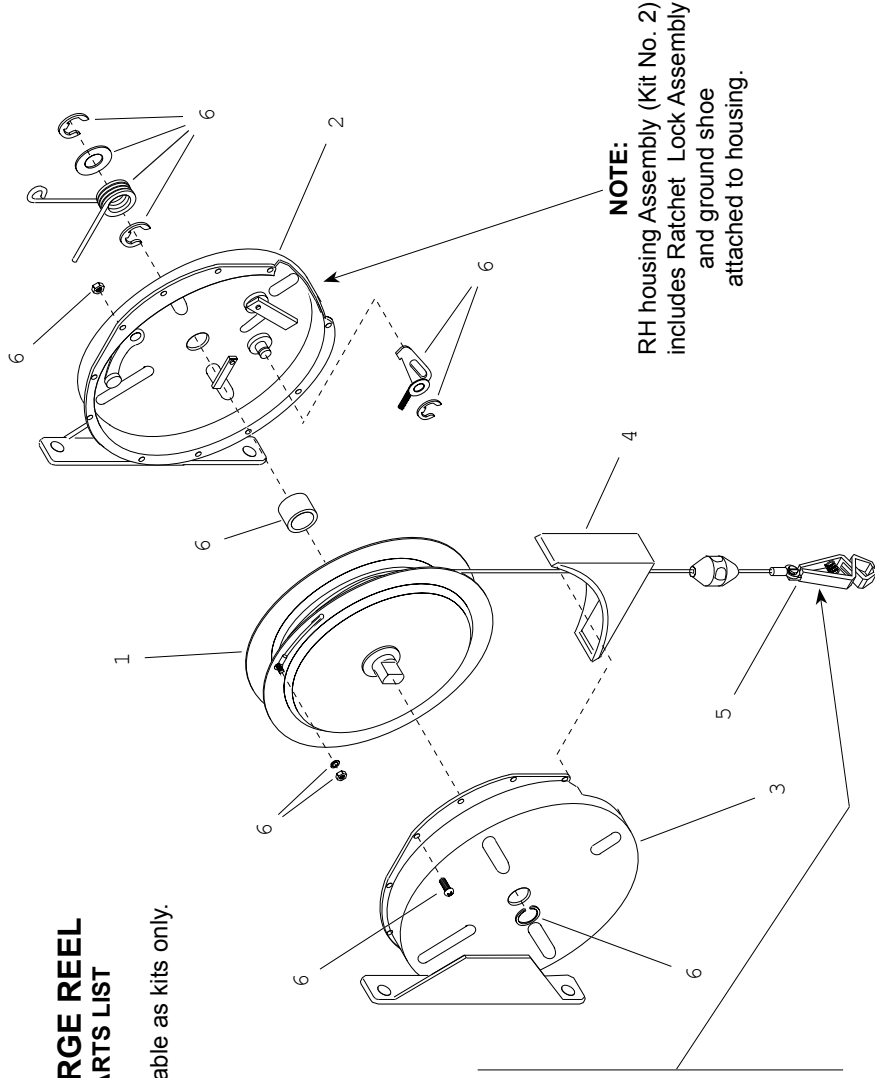

CABLE OPTIONS (Kit Number 5)

"Y" Cable Assembly (two clips), add -Y to the kit number.

EXAMPLE: SD2050-K05-Y

Nylon Covered Cable, add -N to kit number.

EXAMPLE: SD2050-K05-N

Stainless Steel Cable covered with Orange Nylon jacket, add -OS to kit number.

EXAMPLE: SD2050-K05-OS

NOTE:
RH housing Assembly (Kit No. 2) includes Ratchet Lock Assembly and ground shoe attached to housing.

STATIC DISCHARGE REEL

REPLACEMENT PARTS KITS

REFERENCE NUMBER	KIT NUMBER		KIT DESCRIPTION
	Series-2030	Series-2050	
1	SD2030-K01	SD2050-K01	SPRING MOTOR ASS'Y: Spring Motor, Spool, Shaft & Bushings in sealed canister
2	SD2030-K02	SD2050-K02	RH HOUSING ASS'Y: RH Housing Half, Ratchet Lock Assy (attached to housing)
3	SD2030-K03	SD2050-K03	LH HOUSING ASS'Y: LH Housing Half, Nameplate
4	SD2030-K04	SD2050-K04	CABLE GUIDE
5	SD2030-K05	SD2050-K05*	CABLE ASS'Y: Cable, Grounding Clamp(s), Lockwasher-M4, Hex Nut-M4 (See notes below.)
6	SD2030-K06	SD2050-K06	HARDWARE PACKAGE: Spacer, Torsion Spring, Machine Screws, Lockwasher, Thrust Washer, Hex Nut, Retaining Ring, Extension Spring, Ratchet Lock Assembly

* For 2050-Y models with "Y" cable (two grounding clamps), order kit number **SD2050-K05-Y**.
For 2050-N models with Nylon Covered Cable, order kit number **SD2050K05-N**.
For 2050-OS models with Stainless Steel cable covered with Orange Nylon jacket, order kit number **SD2050-K05-OS**.



Zampini Industrial Group

Trusted Industrial Suppliers Since 1986

85 Industrial Circle, Suite 2211

Lincoln, RI 02865

USA

Factory Authorized Gleason Reel Suppliers
FAST Quotes, FAST Delivery!



ZAMPINI INDUSTRIAL GROUP



Contact Us For Your Gleason Reel Products and Parts Today!

Email Us

Call Us

Fax Us



info@AirToolPro.com

1-800-353-4676
1-401-305-7997

1-401-305-7988



We Respond **FAST!**
Minimize Your Downtime!



Numerous Ways To Get Pricing



Guaranteed Satisfaction!
Excellent Service Since 1967!



Everyday Discounts
Quantity Discounts
Email Specials
Low Price Guarantee